

ArcelorMittal Projects Middle East



ArcelorMittal

Complete & customised

Steel solutions



ArcelorMittal – the world’s leading steel and mining company

Steel is as relevant as ever to the future success of our world. As one of the few materials to be completely reusable and recyclable, it will play a critical role in building the circular economy of the future.

At ArcelorMittal, our goal is to help build a better world with smarter steels. Steels made using innovative processes which are more efficient, use less energy, and emit significantly less carbon. Steels that are cleaner, stronger and reusable.

Facts & figures (2023)

Crude steel made

58.1
million tonnes

Employees

126,756

Steel manufacturing

15
countries

Total steel shipments

55.6
million tonnes

ArcelorMittal Projects Middle East

ArcelorMittal Projects Middle East is part of the ArcelorMittal Group and operates as a global one-stop-shop for complete, customised and sustainable steel solutions. At Projects, regional presence and knowledge are combined with worldwide sources and skills. We believe our customers benefit from long-term partnerships, the driving force of our business.

We are highly dedicated to our customers. Whether you are a project owner, decision-maker or contractor, our experts have the necessary technical expertise and quality-driven mindset to deliver value-added solutions to every project.

ArcelorMittal Projects – Our Business Lines

Energy Projects



Complete & customized structural steel package solutions for onshore /offshore energy projects.

Foundation Solutions



Efficient, cost effective & innovative foundation solutions for port, road and railway infrastructure, river and canal embankment and earth / water retention.

Sheet Metal Processing



Providing precision fabricated coated parts to customer’s assembly lines with production facilities in Egypt & China.

ARCELORMITTAL PROJECTS MIDDLE EAST

Customised steel solutions for the Middle East



- **ArcelorMittal Projects Middle East** is the leading specialised steel solutions provider in the United Arab Emirates and Middle East region.
- A global one-stop-shop for complete, customised and sustainable steel solutions and services to projects in **Foundation Solutions, Energy Projects, Water Pipeline and Constructions.**
- **World-class stockyards**, maintaining high levels of safety standards.



Energy projects

- Plates
- Offshore sections
- O&C EPC's
- Fabricators



Proximity / construction

- Plates
- Structural
- Pipes
- HRC, CR, CI
- Value added services



Pipe & coating mill

- HSAW / SSAW
- Anti-corrosion
- Coating
- CWC
- Internal liquid epoxy
- Niche coating



Foundations

- SSP
- Tubular piles
- Trench sheets
- Trench boxes



Sunshine (rental)

- SSP
- Trench boxes



Services & processing



Our world class pipe & coating mill



The **pipe & coating mill** enables Projects Middle East to produce and process high-quality **HSAW / SSAW** pipes for the Middle East and neighbouring countries. This helps us to serve our customers in an even more efficient and flexible way and to provide the most cost-effective solutions.

The pipe mill is strategically located in Sharjah, **United Arab Emirates**, with **the port less than 2 km away**. The location makes it possible to import raw materials and export finished goods cost-effectively, and takes away all logistical challenges.

Our products are backed with the technical expertise of highly qualified people with an average experience of more than 15 years in **HSAW / SSAW pipe** manufacturing and **anti-corrosion coating**. Our products are compliant with International Standards.



Pipe mill: manufacturing capabilities

Pipe dia.: 16"0 to 100"0

Material thickness: 6mm to 25.4mm

Length: 6m to 36m

Grade: up to API 5L X70

Capacity: 150,000 tons per annum



Water line pipe project references

Project	Project owner	Products	Country
173W2020 Transmission Pipeline DN1600/1400 CS from Khurajjah New WDC to Al Ghayl New WDC	Etihad Water & Electricity (Previously FEWA)	3LPE Coated HSAW Pipe with internal CML	UAE
171W2020 Transmission Pipeline DN1600 CS from Khurajjah New WDC to Al Helio WDC	Etihad Water & Electricity (Previously FEWA)	3LPE Coated HSAW Pipe with internal CML	UAE
168W2020 Transmission Pipelines DN1600 CS from Khurajjah New WDC to Burairat WDC - RAK	Etihad Water & Electricity (Previously FEWA)	3LPE Coated HSAW Pipe with internal CML	UAE
167W2020 Transmission Pipelines 2XD-N1800CS from UAQ New 150MIGDRO Plant to Khurajjah New WDC - RAK	Etihad Water & Electricity (Previously FEWA)	3LPE Coated HSAW Pipe with internal CML	UAE
Tender. No.92849 Supply of Carbon Steel Pipes (Zubair to Shunof Suburb)	SEWA	3LPE Coated HSAW Pipe with internal CML	UAE
AMP-SA-22314 Highway 55 Water Pipeline in Oxagon	NEOM	3LPE/ LE Coated Line Pipes + Fittings	KSA
AMP-SA-23087 Water Transmission Pipeline From Magna Bpt to Magna Reservoir	NEOM	3LPE/ LE Coated Line Pipes + Fittings	KSA
AMP-SA-23087 Design & Build for Al Bada'a Storage Reservoir, Al Bada'a Day Tank and Connecting Transmission Mains	NEOM	3LPE/ LE Coated Line Pipes + Fittings	KSA
AMP-AE-0131 N-18670 - New DN1000 Pipeline at Sas Al Nakhl	TRANSCO	3LPE/ LE Coated Line Pipes + FBE Coated Fittings	UAE

Utility services

Chilled water pipeline



Project references

Project	Project owner	Products	Country
District cooling/AD 07 Masdar city connecting	TABREED	Chilled water pipeline	UAE
District cooling develop Dubai South	Dubai South	Chilled water pipeline	UAE
Polygon in Mafraq district cooling	TABREED	Chilled water pipeline	UAE

Anti-corrosion solutions

Anti-corrosion coating on line pipes



ArcelorMittal offers mechanised coating solutions with high standards, customer satisfaction and with all solutions under one roof. This results in an economical product with Quality Controls of the highest standards.

Facilities for anti-corrosion protection for the line pipe include:

External coating

Pipe dia.: 3" to 108"

Coating thickness max: 2000 microns

Length: 18m

Capacity: 1,500,000 sqm per annum

- 3 layer Polyethylene
- 3 layer Polypropylene
- Fusion Bonded Epoxy (single, dual layer)
- Liquid Epoxy, Polyurethane, Anti-Corrosion painting

Internal coating

Pipe dia.: 3" to 108"

Coating thickness max: 2000 microns

Length: 18m

Capacity: 1,500,000 sqm per annum

- Liquid Epoxy Coating
- Liquid Polyurethane Coating
- Food-grade Epoxy, High
- Build Epoxy, Flowcoat, Polyurethane

Concrete weight coating (CWC)

Pipe dia.: 3" to 108"

Coating thickness max: 2000 microns

Length: 18m

Capacity: 1,500,000 sqm per annum



Internal Liquid Epoxy Coating



External Polyurethane Coating



Internal Painting Line



External 3LPE



External 2 LFBE Coating

Anti-corrosion solutions

Anti-corrosion custom coating

Facilities for custom coating include:

- Internal & External Liquid Epoxy coating on Spools and Fittings.
- Internal & External Polyurethane coating on Spools and Fittings.
- Internal & External Fusion Bonded Epoxy coating on line pipes.
- Internal & External Anti-corrosion Painting.



3LPE Coating



FBE Coating



Blasted Bend

External 3LPE coating on Spools and fittings.

External Heat Shrink application on Spools and fittings.

Capability: Size from 3" to 108" bends, tee, branches, flanges, elbows, miter bend reducers, etc.

Type of coating: Food-grade, high build epoxy, flowcoat, polyurethane, external & internal FBE.

Liquid epoxy: Max 2000 microns.

FBE: Max 800 microns.



Anti-corrosion coating project references

Project	Project owner	Products	Country
Callout works contract for ASR Gas Tie-Ins in ASAB Package B	ADNOC Onshore	2LFBE / 3LPP	UAE
Construction of Flowline and wellhead TIE-IN Installations for Conventional wells at ADNOC Onshore fields Package A (ASAB & SAHIL)	ADNOC Onshore	3LPP	UAE
Construction of Flowline and wellhead TIE-IN Installations work in ADCO's Fields Package B (BAB)	ADNOC Onshore	3LPP	UAE
2505775 - GDN Debottleneck and Improving Redundancy Offshore Pipeline from WVS to HMS	TATWEER	2LFBE / CWC	Bahrain
Flowline Hydro Testing, replacement and crossing upgrade (Buhasa/ASAB/SAHIL/Qusahwira/Mender)	ADNOC Onshore	3LPP	UAE
Flowline	Oxy	3LPE	Oman
Construction of Flowlines and wellhead TIE-IN Installation in ADCO's Fields Package B (BAB)	ADNOC Onshore	3LPP	UAE
Callout works contract for ASR gas TIE-INS in ASAB Package B	ADNOC Onshore	2LFBE / 3LPP	UAE
Kalba Lagoon	Sharjah Electricity and Water Authority (SEWA)	External 3LPE / Internal Liquid Epoxy	UAE



Foundation solutions



We offer tailor-made solutions for foundation applications:

- Harbor foundations
- Quay walls
- Platforms applications
- Combi-walls
- Ports applications
- Breakwater walls & jetty foundations

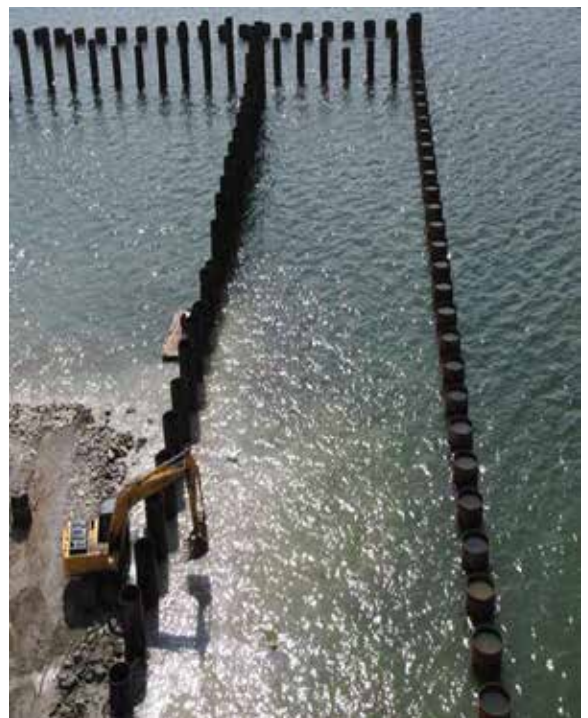

Value-added services provided:

- Tailor-made design solutions with complete
- Accessories: tie-rods, interlocks, struts etc.
- Ready to install steel elements in required lengths
- Logistics, warehousing
- Anti-corrosive coating



Project references

Project	Project owner	Products	Country
Jumeirah Pvt Island	Dubai Municipality	Tubular Pipe	UAE
Rabigh Power Plant	Rabigh Electricity Company	Tubular Pipe	KSA
Aqaba Container Terminal	Aqaba Container Terminal	Combi-Wall, Quay Wall, Deck on Pile structure	Jordan
Jeddah Port	DP World	Tubular Pipe	KSA
LNG Terminal	Bahrain LNG	Tubular Pipe	Bahrain
Hail and Gasha	ADNOC	Tubular Pipe	UAE
Dubai Harbour - Bay Marina	MERAAS	Harbour Foundation	UAE
The Line	NEOM	Casings Pipe	KSA
Jeddah Islamic Container Terminal	Saudi Port Authority	Tubular Pipe	KSA
VLCC Jetty - Fujairah	Port of Fujairah	Tubular Pipe	UAE
Shindhagha Corridor	RTA	Tubular Pipe	UAE
Beach Palace Expansion	Dubai Municipality	Tubular Pipe	UAE
KNPC JETTY	KNPC	Tubular pipe	Kuwait
Neom-Oxagon Port	NEOM	HZN/Sheet Piles	KSA



Foundation solutions - Temporary shoring applications

Our services

- Material rental option
- Sales and buy-back offer
- Design and technical assistance
- Tailor-made solutions

Main products

- Sheet piles
- Tubular piles
- Anchorage solution - tie rods and accessories
- Trench sheets
- Trench boxes



Carbon-steel fabricated fittings



45° Flanged C.S Fabricated Elbow

Approved facility by: Etihad Water and Electricity Authority, TAQA (Transco, ADDC, AADC, ADES), Sharjah Electricity and Water Authority, NEOM, Nama (Oman Water and Wastewater Company).

A **pipe fitting** is a part used in a piping system, for changing direction, branching, or for change of pipe diameter.

Size range: 26" to 100"O

Material thickness: 6mm to 25.4mm

Dim standard: ANSI/AWWA C208

Grade: up to API 5L X70

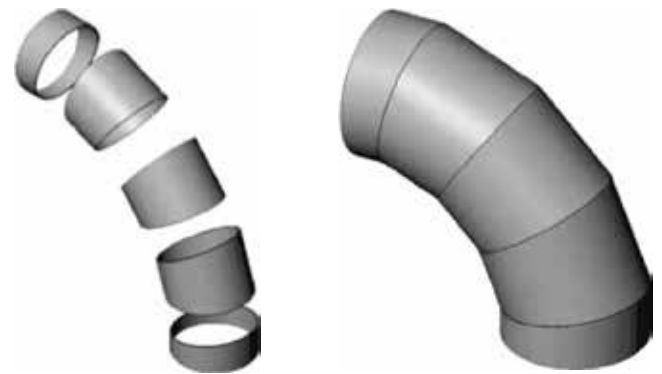

Our main products:

- Equal tee
- Cross
- Reducing tee
- Lateral - equal diameters
- Lateral - unequal diameters
- Wye
- Concentric reducer
- Eccentric reducer
- Two-piece elbow (0° to 22.5°)
- Three-piece elbow (22.5° to 45°)
- Four-piece elbow (45° to 67.5°)
- Five-piece elbow (67.5° to 90°)

Tee and cross (equal/reducing)

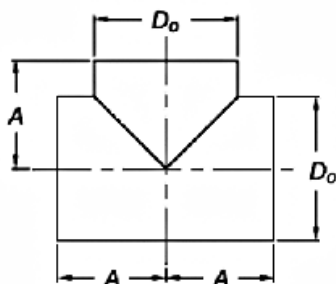

Figure 1A Tee

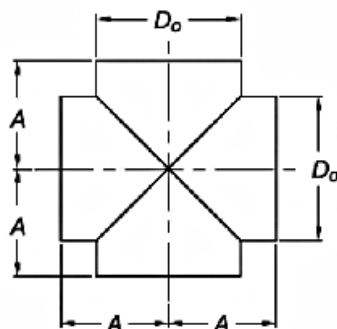

Figure 1B Cross

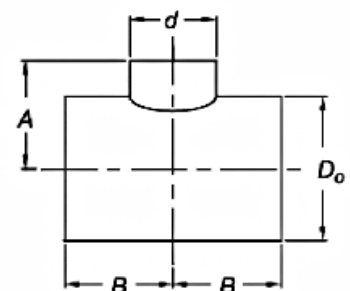

Figure 1C Reducing Tee

Carbon-steel fabricated fittings

Approved facility by: Etihad Water and Electricity Authority, TAQA (Transco, ADDC, AADC, ADES), Sharjah Electricity and Water Authority, NEOM, Nama (Oman Water and Wastewater Company).

A **tee** is type of pipe fitting used for dividing a main flow to two streams or combining flows from two streams. The shape of a pipe tee resembles the letter "T".



Fabrication process:



The plate is rolled into pipe



The pipe is cut into the required shape



The parts are connected to create the final product

Lateral (equal/unequal diameters)

A **lateral** pipe tee is a type of pipe fitting similar to a tee. The difference is that it has a side opening outlet branch at another angle than not 90° .

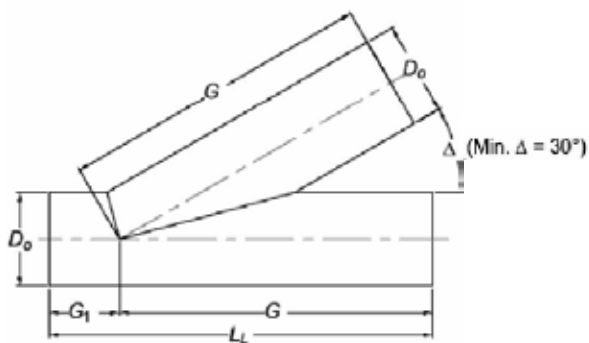

Figure 1D Case I
Lateral (equal diameters)

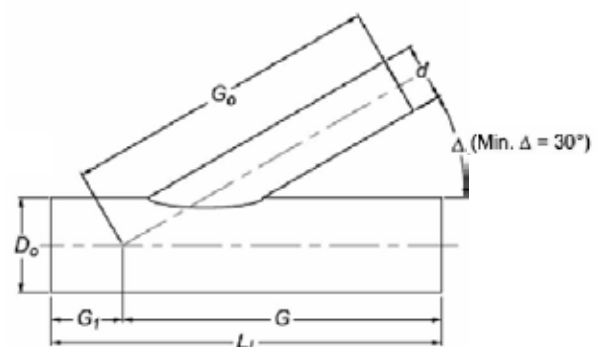

Figure 1D Case II
Lateral (unequal diameters)

Carbon-steel fabricated fittings

Approved facility by: Etihad Water and Electricity Authority, TAQA (Transco, ADDC, AADC, ADES), Sharjah Electricity and Water Authority, NEOM, Nama (Oman Water and Wastewater Company).

90° Wye (bifurcation)

Pipe wyes are used to allow one pipe to join another pipe at some degree or angle. As the name suggests, the pipe wyes are Y-shaped pipe fittings.

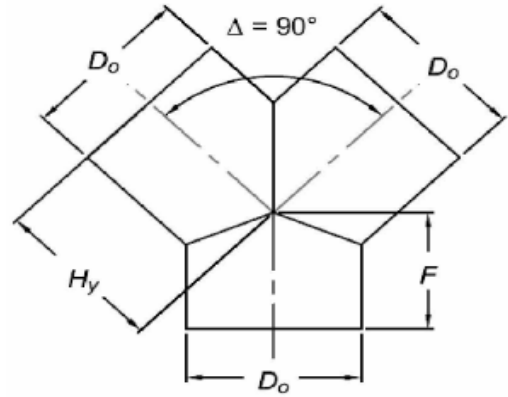

Reducer (concentric/eccentric)

A **reducer** is a pipe fitting which is used in process piping to change the pipe size from a big bore to a smaller bore pipe.

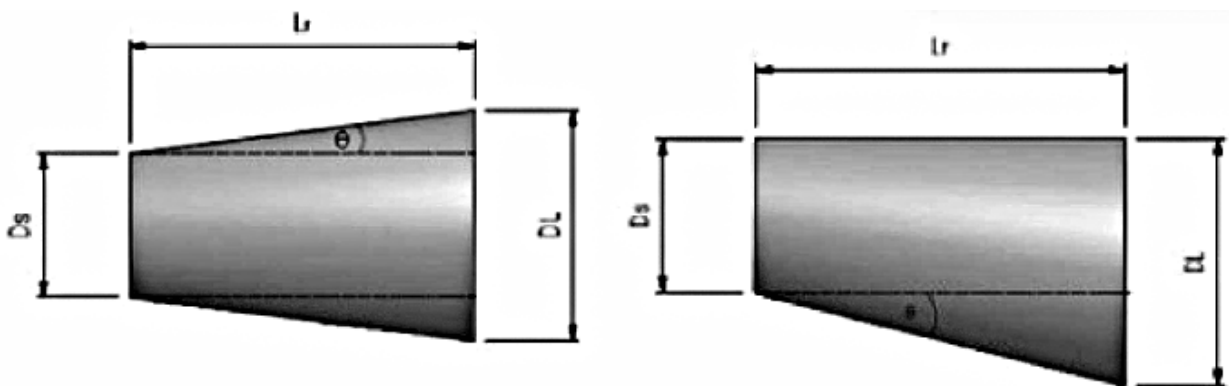

Types of reducers

Concentric reducers: The reduction of the pipe size is achieved by decreasing the diameter of the fitting at a constant rate over a specified length, maintaining symmetry around the fitting.

Eccentric reducers: The reduction of the pipe size is achieved by decreasing the diameter of the fitting at a constant rate over a specified length, one side of the fitting horizontally.

Carbon-steel fabricated fittings

Approved facility by: Etihad Water and Electricity Authority, TAQA (Transco, ADDC, AADC, ADES), Sharjah Electricity and Water Authority, NEOM, Nama (Oman Water and Wastewater Company).

Carbon-steel fabricated bends

A **pipng bend** is a specific, standard, engineered bend pre-fabricated as a spool piece or not, and designed to either be flanged or welded to the piping it is associated with. It is used for changing the direction of the piping. A fabricated bend can be custom-designed at any degree as per site conditions. Although most are categorised as either "short radius" or long radius".



Types of fabricated bends

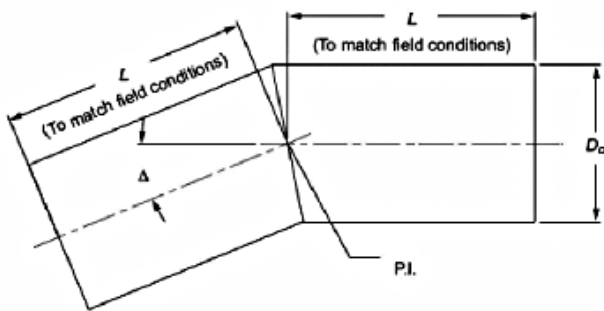

Two-piece elbow (0° to 22.5°)

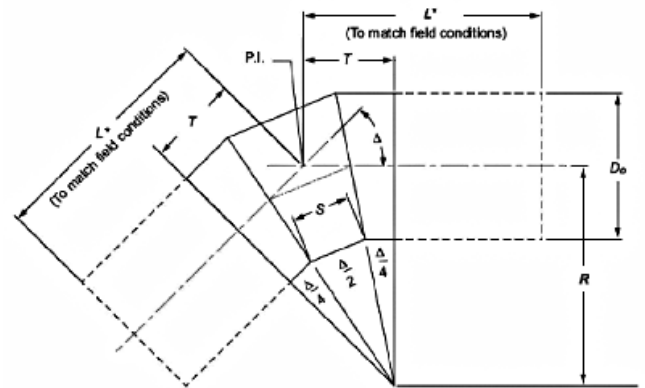

Three-piece elbow (22.5° to 45°)

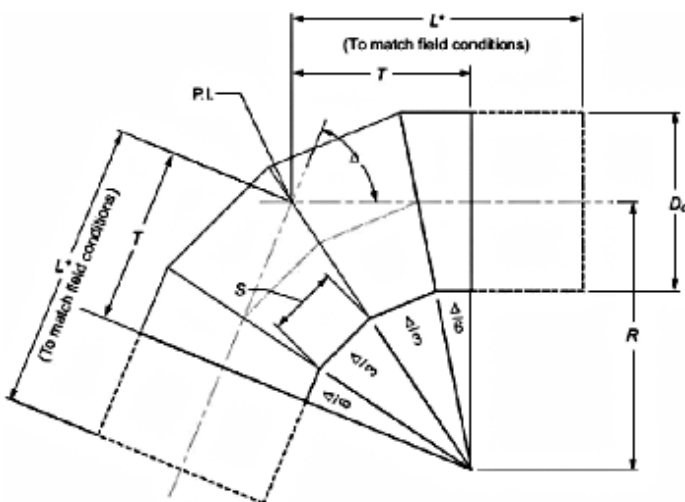

Four-piece elbow (45° to 67.5°)

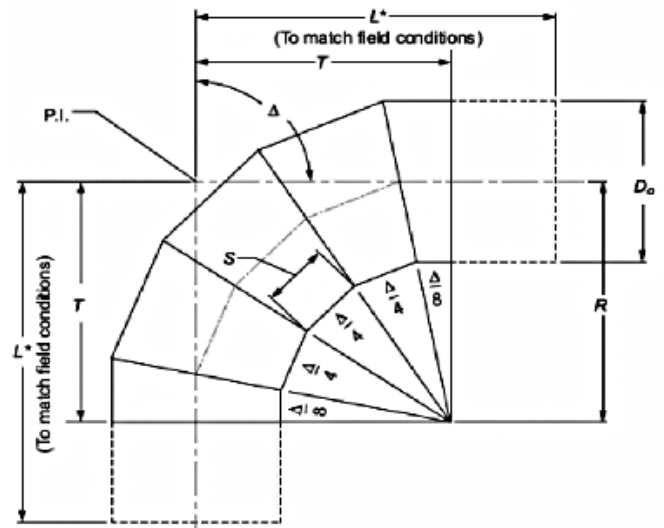

Five-piece elbow (67.5° to 90°)

Dimensions of steel water pipe fittings

Table A.1 Dimensions of steel water pipe fittings

Nominal Diameter		Tee or Cross		Wye, 90°				Equal Diameter Lateral, $\Delta = 30^\circ$ *					
<i>D</i>		<i>A</i>		<i>F</i>		<i>H_y</i>		<i>G</i>		<i>G₁</i>		<i>L_L</i>	
<i>in.</i>	<i>(mm)</i>	<i>in.</i>	<i>(mm)</i>	<i>in.</i>	<i>(mm)</i>	<i>in.</i>	<i>(mm)</i>	<i>in.</i>	<i>(mm)</i>	<i>in.</i>	<i>(mm)</i>	<i>in.</i>	<i>(mm)</i>
4 (4½ OD)	(100)	8	(203)	7	(178)	11	(279)	20	(508)	7	(178)	27	(686)
6 (6¾ OD)	(150)	10	(254)	8	(203)	12	(305)	25	(635)	7	(178)	32	(813)
8 (8¾ OD)	(200)	11	(279)	9	(229)	14	(356)	29	(737)	8	(203)	37	(940)
10 (10¾ OD)	(250)	12	(305)	9	(229)	15	(381)	34	(864)	8	(203)	42	(1,067)
12 (12¾ OD)	(300)	14	(356)	10	(254)	17	(432)	38	(965)	9	(229)	47	(1,194)
14	(350)	15	(381)	10	(254)	17	(432)	41	(1,041)	9	(229)	50	(1,270)
16	(400)	16	(406)	11	(279)	19	(483)	45	(1,143)	10	(254)	55	(1,397)
18	(450)	17	(432)	12	(305)	20	(508)	49	(1,245)	10	(254)	59	(1,499)
20	(500)	18	(457)	13	(330)	22	(559)	54	(1,372)	11	(279)	65	(1,651)
22	(550)	20	(508)	13	(330)	23	(584)	58	(1,473)	12	(305)	70	(1,778)
24	(600)	21	(533)	14	(356)	24	(610)	62	(1,575)	12	(305)	74	(1,880)
30	(750)	25	(635)	16	(406)	29	(737)	75	(1,905)	14	(356)	89	(2,261)
36	(900)	29	(737)	18	(457)	33	(838)	88	(2,235)	15	(381)	103	(2,616)
42	(1,050)	33	(838)	20	(508)	37	(940)	101	(2,565)	17	(432)	118	(2,997)
48	(1,200)	36	(914)	22	(559)	41	(1,041)	114	(2,896)	19	(483)	133	(3,378)
54	(1,350)	40	(1,016)	24	(610)	45	(1,143)	127	(3,226)	20	(508)	147	(3,734)
60	(1,500)	44	(1,118)	27	(686)	50	(1,270)	140	(3,556)	22	(559)	162	(4,115)
66	(1,650)	48	(1,219)	29	(737)	54	(1,372)	153	(3,886)	24	(610)	177	(4,496)
72	(1,800)	52	(1,321)	31	(787)	58	(1,473)	165	(4,191)	25	(635)	190	(4,826)
78	(1,950)	56	(1,422)	33	(838)	62	(1,575)	178	(4,521)	27	(686)	205	(5,207)
84	(2,100)	60	(1,524)	35	(889)	67	(1,702)	191	(4,851)	29	(737)	220	(5,588)
90	(2,250)	63	(1,600)	37	(940)	71	(1,803)	204	(5,182)	30	(762)	234	(5,944)
96	(2,400)	67	(1,702)	39	(991)	75	(1,905)	217	(5,512)	32	(813)	249	(6,325)
102	(2,550)	71	(1,803)	41	(1,041)	79	(2,007)	230	(5,842)	34	(864)	264	(6,706)
108	(2,700)	75	(1,905)	43	(1,092)	83	(2,108)	243	(6,172)	35	(889)	278	(7,061)
114	(2,850)	79	(2,007)	45	(1,143)	88	(2,235)	256	(6,502)	37	(940)	293	(7,442)
120	(3,000)	83	(2,108)	48	(1,219)	92	(2,337)	269	(6,833)	39	(991)	308	(7,823)
126	(3,150)	87	(2,210)	50	(1,270)	96	(2,438)	282	(7,163)	40	(1,016)	322	(8,179)
132	(3,300)	90	(2,286)	52	(1,321)	100	(2,540)	295	(7,493)	42	(1,067)	337	(8,560)
138	(3,450)	94	(2,388)	54	(1,372)	104	(2,642)	307	(7,798)	44	(1,118)	351	(8,915)
144	(3,600)	98	(2,489)	56	(1,422)	109	(2,769)	320	(8,128)	45	(1,143)	365	(9,271)



ArcelorMittal



Energy Projects

Complete & customised structural steel package solutions for onshore and offshore energy projects.

Key market segments

- Offshore oil & gas
- Onshore downstream
- OCTG (Oil Country Tubular Goods)
- Line pipe
- Offshore wind

Energy Projects provides comprehensive and customised structural steel solutions to the international energy sector. We offer a full range of structural steel products from our own ArcelorMittal mills, supported by an extensive global network of third-party suppliers and specialty stocks located near major energy generation sites.



Project services

Energy Projects supports its customers throughout the life cycle of each project. Depending on the client's or project's needs, we offer a range of tailor-made services.

We provide a comprehensive range of value-added services, such as:

- Project management & documentation
- Quality assurance & controls
- Logistic forwarding & warehouse services
- Frame agreements
- Technical support & consultancy
- Prefabrication & processing

Project solutions

- Alupur®
- Beams & sections
- Bulb flats, hollow sections & merchant bars
- Krybar®
- Mooring wire systems
- Pipes & tubes
- Plates

Our stock program & product range

High yield seamless pipes:

- API 5L X52/L360 PSL 2
- S355NLHHO (S355G14+N)
- Norsok M-120 Y22

High yield SAW pipes:

- API 5L X52/L360 PSL 2
- API 5L X56/L390 PSL 2
- API 5L X65/L450 PSL 2

High yield offshore plates:

- API 2W Gr 50
- S355MLO (S355G9+M)
- EN10225-1:2019 S420MLO (S420G1+M)
- EN10225-1:2019 S460MLO (S460G1+M)
- Norsok M-120 Y20/Y30/Y40

Boiler quality plates

- ASTM / ASME A/SA 516 GR60/65/70 NACE MR0175

HIC tested pressure vessel plates

- ASTM / ASME A/SA 516 GR60/65/70 INDUSTRIEEL CARELSO HIC PREMIUM+

European sections

- S355J2+M / EN 10025

High yield offshore sections

- EN10225-2: 2019 S355MLO (S355G11+M)
- EN 10025 S355ML
- Norsok M-120 Y26

Product range

Steel plates

All plates are manufactured by globally reputable steel manufacturers and are available from our global stocking facilities or project-specific production allocations with partner mills. We also offer a range of special quality BQ and HIC material and can cut plates to various sizes to meet your fabrication and design requirements.

- Plate thickness range: 5mm to 760mm
- Yield strength range: 355 – 690 N/mm²

Alupur®

Alupur® is the solution for insulation jacketing in refineries, the petrochemical industry, gas power plants, oil storage facilities, and LNG terminals. Coated on both sides with 50µm pure aluminum (300 gr/m²), Alupur® offers excellent fire and corrosion resistance. The combination of high-quality steel and aluminum properties provides superior fire resistance at temperatures up to 1100°C.

Advantages:

- Superior passive fire resistance
- Excellent corrosion resistance
- Thermal and light reflectivity

Range:

- Available from stock up to 1.91 mm
- PVDF coating in RAL colors
- Corrugated sheets with different profiles



Beams & sections

Our beams and sections range includes the following sizes, along with prefabrication services upon request:

British:

- UBL 152x89 to 1100x400
- UC 152x152 to 356x406

American:

- W: 4"x4" to 44"x16"

European:

- HE 100 to 1000
- IPE 180 to 750
- UPE 180 to 400

Chinese:

- HW 100 to 1000
- HM 150x100 to 600x300
- HN 200x100 to 900x300
- Beam height: 100mm – 1100mm
- Beam breadth: 100mm – 420mm

Bulb flats, hollow sections & merchant bars

Bulb Flats:

Bulb flats are used as plate stiffeners, especially in the shipbuilding industry. Our supply width ranges from 60mm to 430mm and can be provided according to EN 10225 / S355G11+N. Our bulb flats are approved by various shipbuilding classifications including ABS, LR, GL, DNV, Lloyds, BV, Russian, Korean, and Japanese Registers.

Hollow sections:

Hollow sections can be provided according to EN 10210 / EN 10219 / S355NLH, suitable for all construction and mechanical applications. Size range:

- Circular: 26.9mm to 508mm outside diameter
- Rectangular: 30mm x 20mm to 600mm x 400mm
- Square: 20mm x 20mm to 400mm x 400mm

Merchant bars:

A full range of equal, unequal angles, flat and round bars can be provided according to EN 10025.

Krybar®

Krybar® is a specially designed reinforced steel bar for the construction of cryogenic LNG tanks. ArcelorMittal has been producing Krybar® since 1980 and it has been used in more than 250 tanks worldwide. Due to its special composition and rolling process, Krybar® has high ductility even at very low temperatures, down to -170°C (240°F), all in accordance with BS7777 and EN 14620.

ArcelorMittal offers a wide range of Krybar® grades depending on the design temperature of the tank:

- Krybar® -50 for LPG tanks with temperature down to -50°C
- Krybar® -105 for ethyl tanks with temperature down to -105°C
- Krybar® -620 & Krybar® -165 for LNG tanks with temperature down to -170°C

Mooring wire systems

Our mooring wire systems are engineered for the long-term mooring of floating production systems such as FPSO, turrets, and floating wind turbines in seawater depths of up to 1500m.

Mooring wire characteristics

- Sheathed spiral strand
- High strength with good torque balance
- Diameters from 50mm upwards
- Sheathing from 9mm to 24mm
- Dual color sheathing for easy visual product inspection
- Corzsal coated wires for increased corrosion resistance
- Range of sockets and connector options available

Other specifications can be manufactured on request according to requirements.

Pipes & tubes

Different pipes and tubes:

- Welded products
- OCTG
- Seamless products

Welded products for the following applications:

Offshore structural & large diameter line pipes

- Rolled tubulars formed from plate by either press bending, roll bending, UOE, or JCO method
 - International standards: API 2B, API 5L, and EEMUA 158
 - Joined by Submerged Arc Welding process according to AWS D1.1 in the longitudinal direction
- Welded LSAW and HSAW:
 - Outer diameter range from 14" to 200"
 - Wall thickness range from 12.7mm to 150mm
- Additional services - external coatings:
 - Polyethylene, Polypropylene



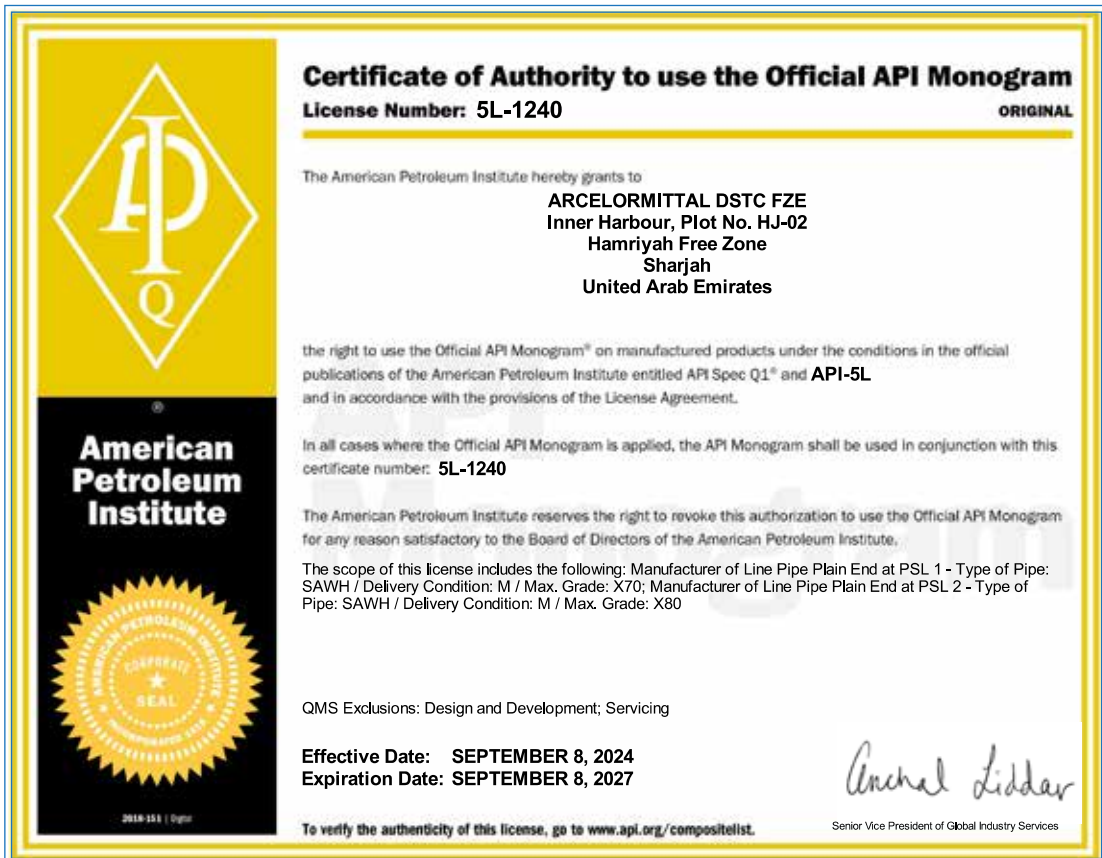
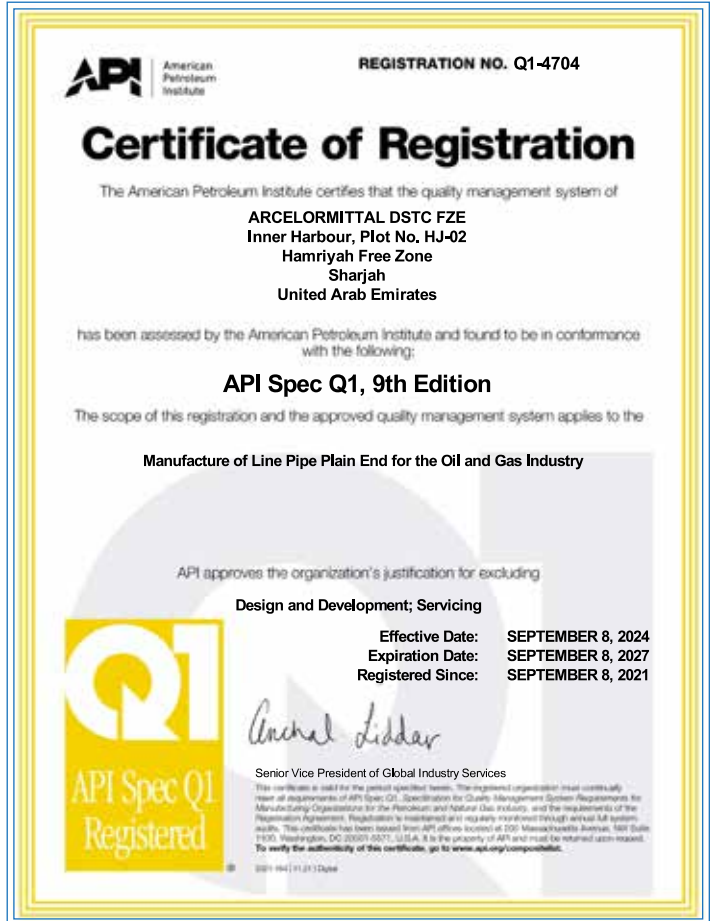



Certificates and approvals

    								
COMMERCIAL DIRECTORY VENDORS LIST								
Product Group : 0107030								
Description : PIPES – CARBON STEEL								
Manufacturer Principal	Name	Country Plant Address	Agent Name Evaluated by	SEC decision Approval date	Models	Conditions	Remarks	Validation date
99463371	ARCELORMITTAL DSTC FZE.	United Arab Emirates SHARJAH	ARCELORMITTAL PROJECTS L.L.C. RPOSC	08-Apr-20 576/G/RPOC/ 16/2021 07-Oct-2021	(HSAW 400 TO 2000 DN)			07-Oct-2026

    								
COMMERCIAL DIRECTORY VENDORS LIST								
Product Group : 0107220								
Description : CARBON STEEL PIPE FITTINGS								
Manufacturer Principal	Name	Country Plant Address	Agent Name Evaluated by	SEC decision Approval date	Models	Conditions	Remarks	Validation date
99491873	ARCELORMITTAL DSTC FZE	United Arab Emirates DUBAI	RPOSC	231/G/RPOC/ 05/2024 09-Mar-2024	RANGES OF 10" TO 100"	PROVIDING FULL TIME TPIA WITNESS BY CONTRACTOR FOR FIRST PROJECT WITH TRANSCO		09-Mar-2029

    								
COMMERCIAL DIRECTORY VENDORS LIST								
Product Group : 0107080								
Description : PIPES - EXTERNAL COATINGS								
Manufacturer Principal	Name	Country Plant Address	Agent Name Evaluated by	SEC decision Approval date	Models	Conditions	Remarks	Validation date
99463371	ARCELORMITTAL DSTC FZE.	United Arab Emirates SHARJAH	ARCELORMITTAL PROJECTS L.L.C. RPOSC	576/G/RPOC/ 16/2021 07-Oct-2021				07-Oct-2026

    								
COMMERCIAL DIRECTORY VENDORS LIST								
Product Group : 0107085								
Description : PIPES - INTERNAL COATINGS								
Manufacturer Principal	Name	Country Plant Address	Agent Name Evaluated by	SEC decision Approval date	Models	Conditions	Remarks	Validation date
99463371	ARCELORMITTAL DSTC FZE.	United Arab Emirates SHARJAH	ARCELORMITTAL PROJECTS L.L.C. RPOSC	222G/RPOC/ 05/2024 03-Mar-2024	FUSION BONDED EPOXY UP TO 12 M LENGTH	PROVIDING FULL TIME TPIA WITNESS BY CONTRACTOR FOR FIRST PROJECT WITH TRANSCO		06-Mar-2029

Our principles include

Water & utilities



Energy



Ports / marine



ArcelorMittal DSTC FZE
P.O. Box 8386
Jebel Ali, South Zone,
Dubai
United Arab Emirates
T: +971 4 80 36 666
F: +971 4 80 36 667
E: am.dstc@arcelormittal.com

ArcelorMittal Arabia Project Company
T: +966 555923153/+966 538171971
F: +966 569753955
E: am.dstc@arcelormittal.com

ArcelorMittal Downstream Solutions Muscat
T: +971 4 8036 666
F: +971 4 8036 667
E: am.dstc@arcelormittal.com

ArcelorMittal DSTC FZE – Hamriyah Branch
Inner Harbor Plot No. HD-20,
21A1A, 21A1B & HJ-02, 02A
Hamriyah Free Zone, Sharjah
United Arab Emirates
T: +971 6 59 14 777
F: +971 4 80 36 667
E: am.dstc@arcelormittal.com

ArcelorMittal Distribution Solutions Qatar
PO Box Building No. 109, Zone 90, Street 217
Unit No: UA 08, Urn Al Houf
Free Zone, Doha, State of Qatar
T: +974 4 465 00 86
F: +974 4 467 61 72
E: am.dstc@arcelormittal.com

Visit our website



projects.arcelormittal.com

